

# COMMUNITY PLAZA EAST

1630 E. Shaw Ave.

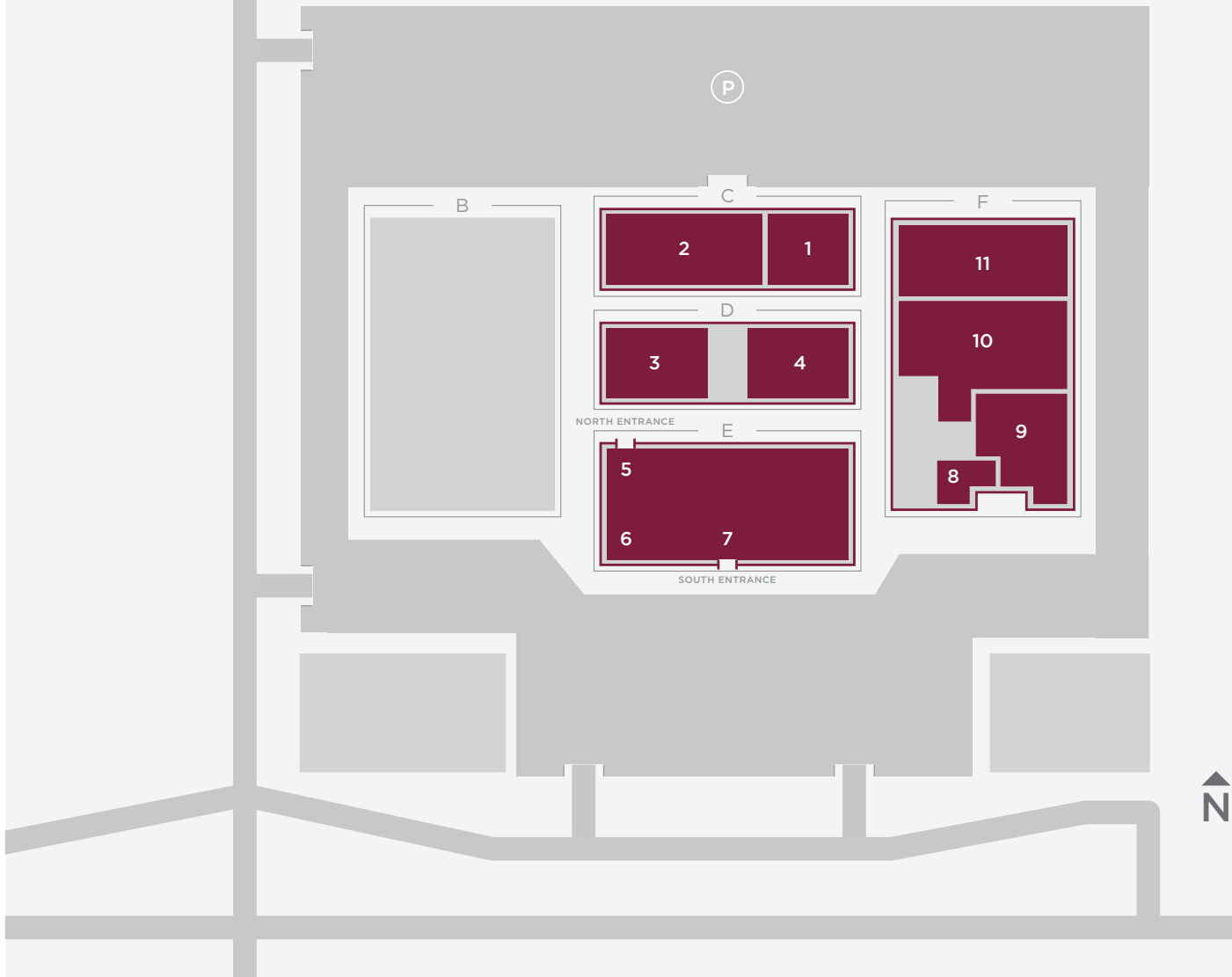

- 1 Kaiser Permanente - Hearing Center | Tenant**  
1630 E. Shaw Ave., Building C, Suite 124
- 2 Auditorium**  
1630 E. Shaw Ave., Building C, Suite 160
- 3 Centralized Staffing Office**  
1630 E. Shaw Ave., Building D, Suite 135
- 4 Home Health - Administration**  
1630 E. Shaw Ave., Building D, Suite 154
- 5 Pre-Registration | North Entrance**  
1630 E. Shaw Ave., Building E, Suite 150
- 6 Utilization Review | North Entrance**  
1630 E. Shaw Ave., Building E, Suite 150

- 7 Clinical Informatics, Epic Education, Physician Education, Community & Outreach | South Entrance**  
1630 E. Shaw Ave., Building E, Suite 150
- 8 Occupational Health**  
1630 E. Shaw Ave., Building F, Suite 163
- 9 Home Health - Home Infusion Pharmacy**  
1630 E. Shaw Ave., Building F, Suite 167
- 10 Home Health - Administration**  
1630 E. Shaw Ave., Building F, Suite 172
- 11 Supply Chain Management**  
1630 E. Shaw Ave., Building F, Suite 176



[CommunityMedical.org](https://CommunityMedical.org)